

Problem solving

If the Bold does not work, check the following:

- whether you have connected the separately supplied Bluetooth module to the plug.

Open the Aemster App and check:

- whether the current time is selected.
- whether the current day of the week is selected.
- whether the operating period is on/off.

In case of a reduced sense of smell:

- check whether the bottle is still properly filled.
- Clean the Bold as described on the next page.

In case you have forgotten your Aemster APP password:

- On the bluetooth module press and hold the reset button for 3 seconds. The device will now reset to the password 8888

Manual Bold

Your professional Scent Diffuser

The secret art of creating beautiful scented rooms.



Congratulations on your new scent diffuser, called Bold.
This manual shows you how to set up and use your Bold for the optimal scent experience in your environment.

Cleaning the Bold

Every time you use a new scent, we recommend that you clean the scent diffuser.

You do this as follows:

1. Turn off the scent diffuser
2. Unscrew the empty bottle and fill it with approximately 100ml of Aemster diffuser cleaner
3. Turn the bottle in the Bold and let it diffuse for 10-15 minutes.
4. Unscrew the bottle and remove the diffuser cleaner
5. Fill the bottle with your new Aemster scent

AEMSTER

Specifications:

Product name : Bold
Control : Bluetooth App
Capacity : 1000ML
Dimension : 148cm"W x 473cm"H
Weight : 3.1kg
Input voltage : 110-240V AC
Output voltage : DC12V



Aemster

Uilenstede 475, 1183AG Amstelveen,
NL +31 (0)85 130 84 91
hello@aemster.com
www.aemster.com
Chamber of Commerce: 81517629

Before you start:

- The scent diffuser must always remain upright; if it falls over, the scent oil will leak out.
- Keep out of reach of children.
- Prevent the scent oil from coming into contact with delicate surfaces.
- Do not use the scent diffuser if any part is broken.



Nebulizing technology and performance

The cold air nebulizing technology spreads the scent throughout the room in ultra-fine, dry little particles. This results in a consistent, even and perfectly balanced scent in your environment. Place the Bold in a location where you can take advantage of the natural airflow and try different locations and settings until you are satisfied with the scent experience.

Components



Main body



Empty bottle

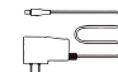

Plug

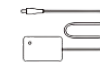

Bluetooth module



Key

1. Pour the scent oil into the Bold scent diffuser

- Unlock the top of the Haevn Bold with the included key
- Pull the top of the diffuser up from the main body - including the blue empty bottle.
- Unscrew the blue empty bottle.
- Fill the blue empty bottle with Aemster scent oil (only use Aemster scent oil, do not mix with water!)
- Screw the bottle back into the diffuser top.
- Place the diffuser top in the main housing and turn the top so that the protrusion fits in the hole of the main housing ('male/female' principle).
- The top should fall completely into the diffuser, it should not protrude.

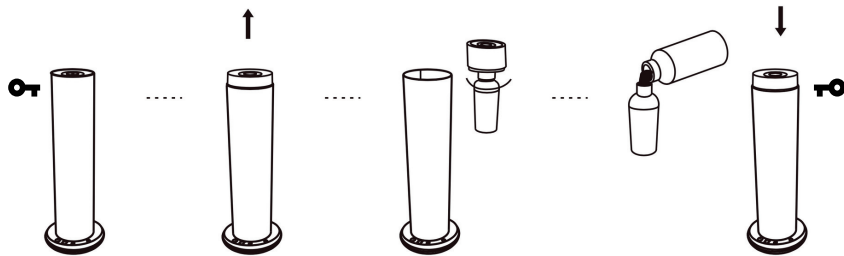

2. Now turn on the Bold scent diffuser

- Connect the plug to the Bluetooth module.
- Plug the plug into a socket. Tip: the Bold is a powerful scent diffuser, so start at the lowest level and intensify the scent experience from there.

The diagram below shows the default settings:

Level	Nebulization	Pause	Consumption
G1	15s	300s	0.30
G2	15s	150s	0.40
G3	20s	120s	0.50
G4	20s	85s	0.60
G5	25s	80s	0.70
G6	30s	75s	0.80
G7	30s	60s	0.90
G8	30s	50s	1.00
G9	30s	40s	1.10
G10	30s	33s	1.20
G11	33s	30s	1.28
G12	40s	30s	1.36
G13	50s	30s	1.44
G14	60s	30s	1.52
G15	75s	30s	1.60
G16	80s	25s	1.68
G17	85s	20s	1.76
G18	120s	20s	1.84
G19	150s	15s	1.92
G20	300s	15s	2.00
Customized	5-500s	5-500s	----

3. Setting automatic on/off times

Download the Aemster App from the Apple or Google Play store.

You must always be within 10 meters of the scent diffuser to make an adjustment to the settings.



- Make sure the Bluetooth function of your smart phone/tablet is turned on
- Open the Aemster App
- Select the Bold scent diffuser
- Enter the password: 8888
- Press login

You can change your password in the App. Go to "About" and press "Change password".

4. Personalizing the scent diffuser via the Aemster App

You can set up to 5 automatic work periods. This is very useful if, for example, you want the diffuser to switch on/off at fixed times. You do this as follows:

- Click on the top work period
- Activate the desired days of the week
- Select at grade 1-20 to increase/decrease the intensity or select the box at "custom" for a custom intensity.

